

LorX[®]

cervical peek cage with blade



 Tria Spine[®]
SPINE | ORTHOPEDICS

DESIGN FEATURES

Better Stability

two instrument holes for extra stability during insertion
1.5mm fixation of blade into the each endplate

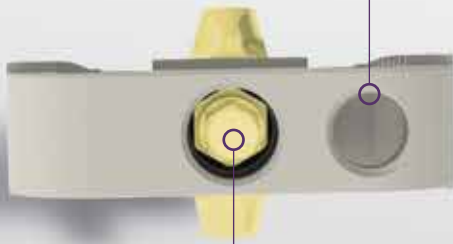

Biomechanically tested

high success in biomechanical tests due to the special shaft and body design

Anatomical Shape

original and anatomical design for a secure and better placement

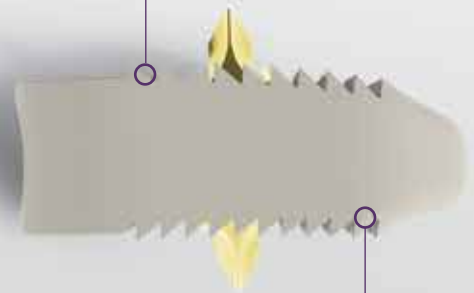

Special Blade Design

specially designed (patent pending) titanium blade, positioned in the middle of the cage for perfect fixation

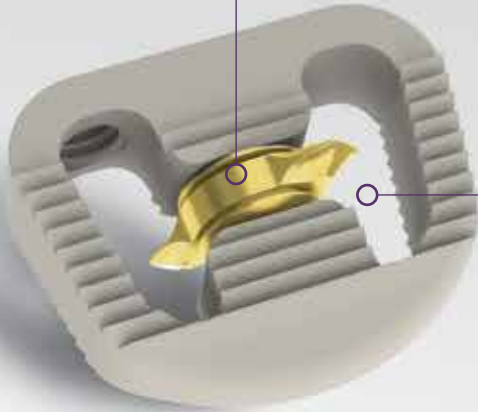

Biocompatibility

radiolucent and biocompatible PEEK material (VESTAKEEP by Evonik, ASTM F2026) which provides modulus of elasticity similar to the bone

Enhanced Bone Fusion

two adequate graft spaces for bone fusion

LorX[®] Cervical Peek Cage with Blade

LX-02-525	15 x 12 mm	5 mm
LX-02-526	15 x 12 mm	6 mm
LX-02-527	15 x 12 mm	7 mm
LX-02-528	15 x 12 mm	8 mm